

F7022 – Isolated CANBus 7” LCD indicator with voice

Installation manual

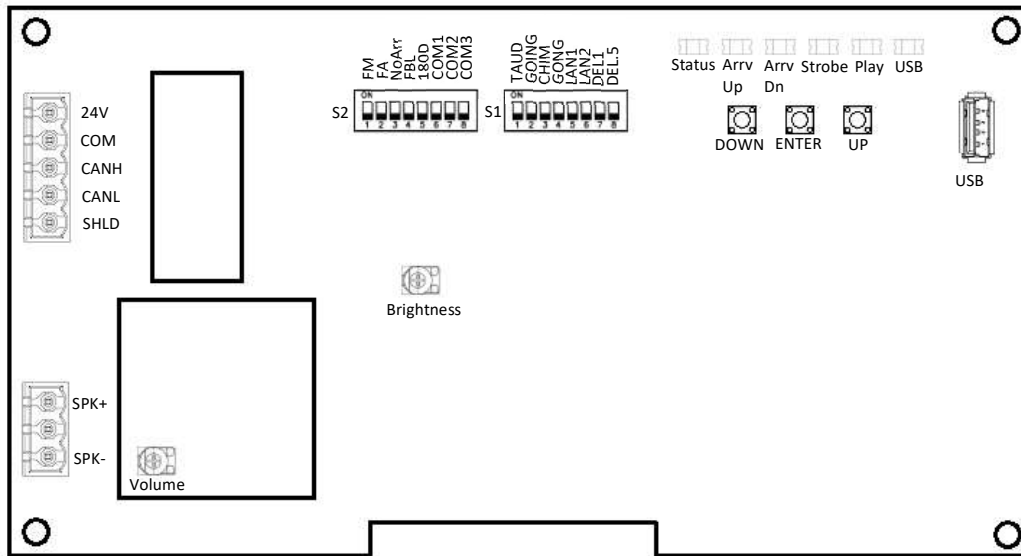

- Supply must be between 16VDC to 28VDC.
- Speaker must be 4Ω to 45Ω, 5Watts minimum.
- Up to 12 minutes 38 seconds of message time.
- Speaker wire length must be less than 500 feet to prevent noise.
- .via files are for audio configuration. Only one .via file must be present on the USB dongle.
- .via and visual files must be place on the root of a USB dongle, then connected to a powered voice until the USB light stops blinking.
- Must be installed in COP.
- Brightness of the LCD is controlled by “brightness” potentiometer.
- Volume of the voice annunciator is controlled by “volume” potentiometer.
- Press ENTER to go the main menu of the LCD, then navigate with UP/DOWN switches. Refer to F7022 operation manual on our website.
- Status LED :

Status LED State	Description
Steady	No communication
Slow Blink	System error
Fast Blink	Communication active with no error

SW #	#	Text	Description									
S2	1	FM	ON -> Blank the display in fire mode									
	2	FA	ON -> Blank the display in fire alternate mode									
	3	NoArr	ON -> Blank the arrow									
	4	FBL	ON -> 100% backlight intensity OFF -> 80% backlight intensity (Backlight life enhanced)									
	5	180D	ON -> Portrait mode (If existing within the config)									
	Communication		CAN JRT	CAN JRT	CAN Thyssen							
	6	COM1		●								
	7	COM2			●							
	8	COM3										
S1	1	TAUD	ON -> Play all audio file saved in memory									
	2	GOING	ON -> Going Up/Dn active									
	3	CHIM	ON -> Passing Chime active									
	4	GONG	ON -> Cabin gong active									
	Language		French	English	1 - French 2 - English	1 - English 2 - French						
	5	LAN1		●		●						
	6	LAN2			●	●						
	7	DEL1	ON -> Add 1 second of silence after the strobe									
	8	DEL.5	ON -> Add 0.5 second of silence after the strobe									

- **Play Test option (TAUD):** The device will play each voice file saved in the system in loop and will display the ASCII associated with the file playing.
- **Going Option (GOING):** The voice will play the file associated with the type « Going UP » or « Going Down » when STRB is asserted AND TRV UP or TRV DN.
- **Chime Option (CHIM):** The voice will play the file associated with the type « CHIME » each time the stair are changing.
- **Gong Option (GONG):** The voice will play the file associated with the type « Gong UP » or « Gong Down » when ARR DN or ARR UP are asserted.